

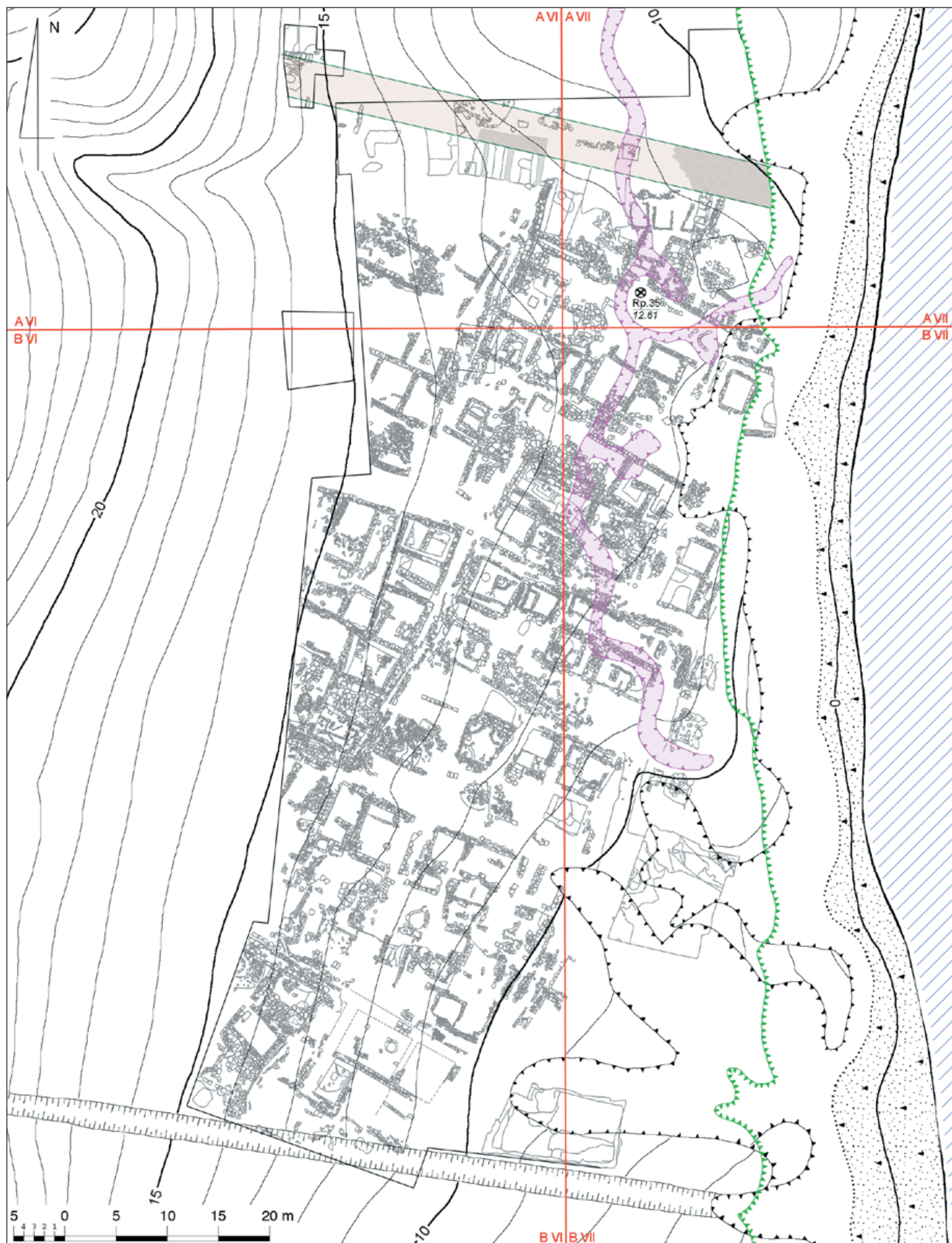

1 • General view of the Lower City of Olbia.



2 • General view of the central and southern part of the Northern Houseblock. View from the west.



Overview plan of Sector NGS with topography of surrounding territory and infringements in cultural layers as a result of the erosion of the coastal cliff (green line) and trenches made during the Second World War (in pink). To the north, the area of the city wall (in yellow).



Overview plan of Sector NGS.



1-3 • General view from the Upper City over Sector NGS. View from the west.

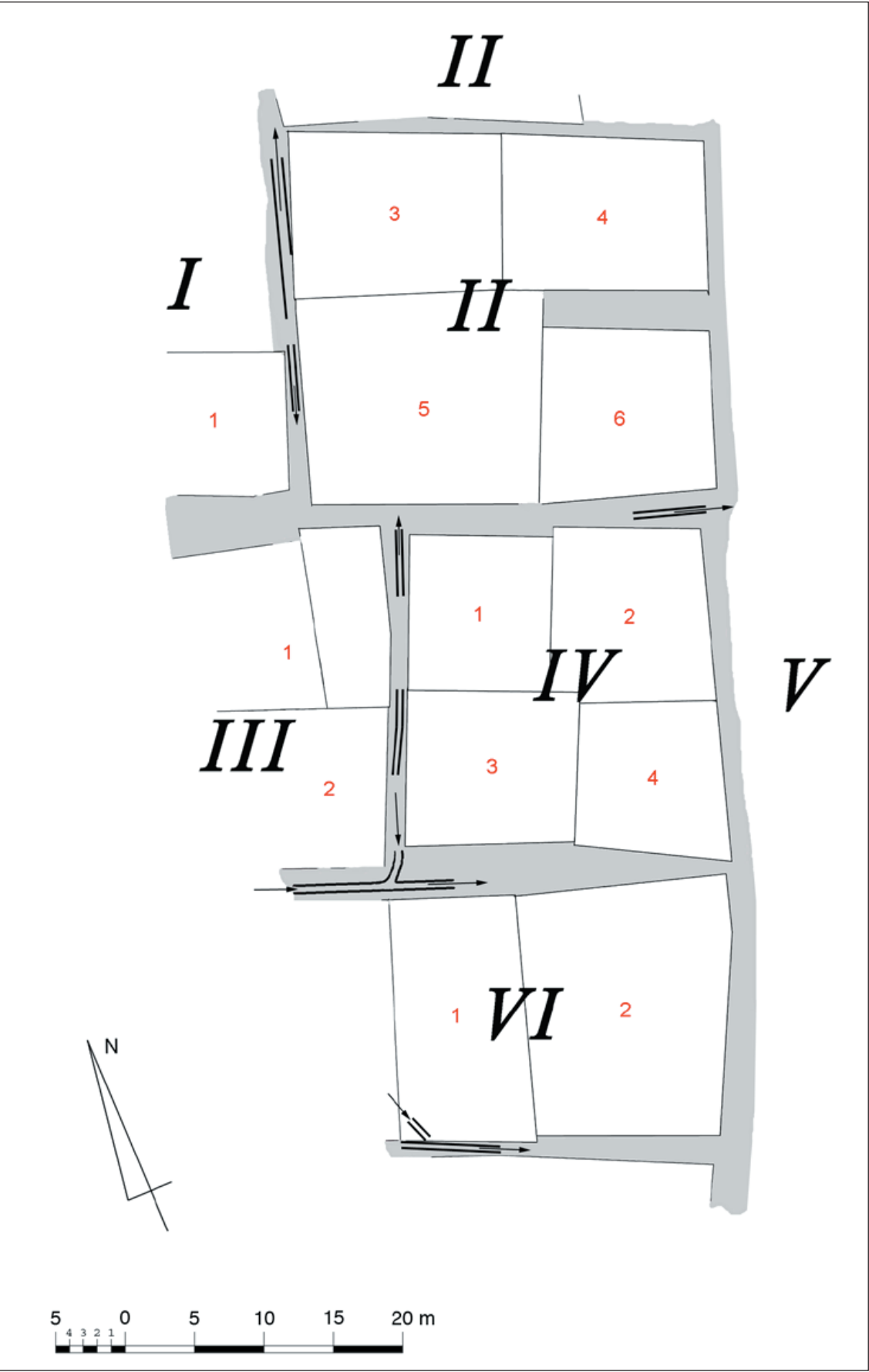

The general arrangement of houseblocks and streets.



1-2 • Pavement of Northern Transversal Street. View from the east.



1 • Western Longitudinal Street. To the right of the street are the remains of Houses I-1 and I-2; to the left House II-3. View from the north.



2 • Drain 153 in the eastern part of Northern Transversal Street. View from the west.



3 • The longitudinal western wall of the Drain 27 in Houses I-1 and I-2. View from the north.

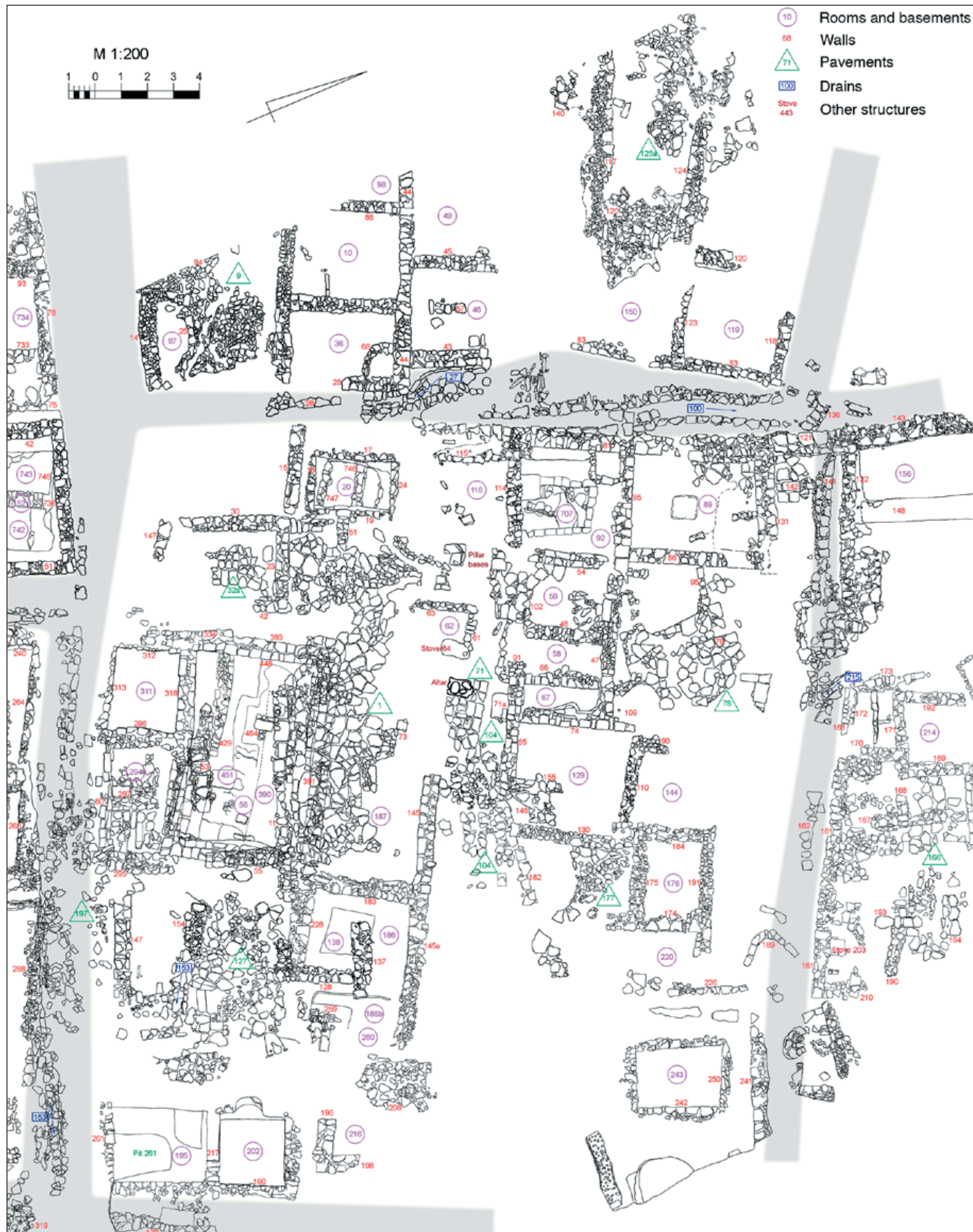

Overview plan of Northern and Northwestern Houseblocks.



1 • House I-1. In the foreground, the pavement of Northern Transversal Street in the middle the southern external wall of the house. Further the courtyard and behind it Rooms 10 and 36. View from the south.



2 • House I-1, Rooms 10 and 36. View from the southwest.



1 • House I-1, doorway in the southern external wall of the house. View from the southeast.



2-3 • House I-1. Plan and reconstruction.

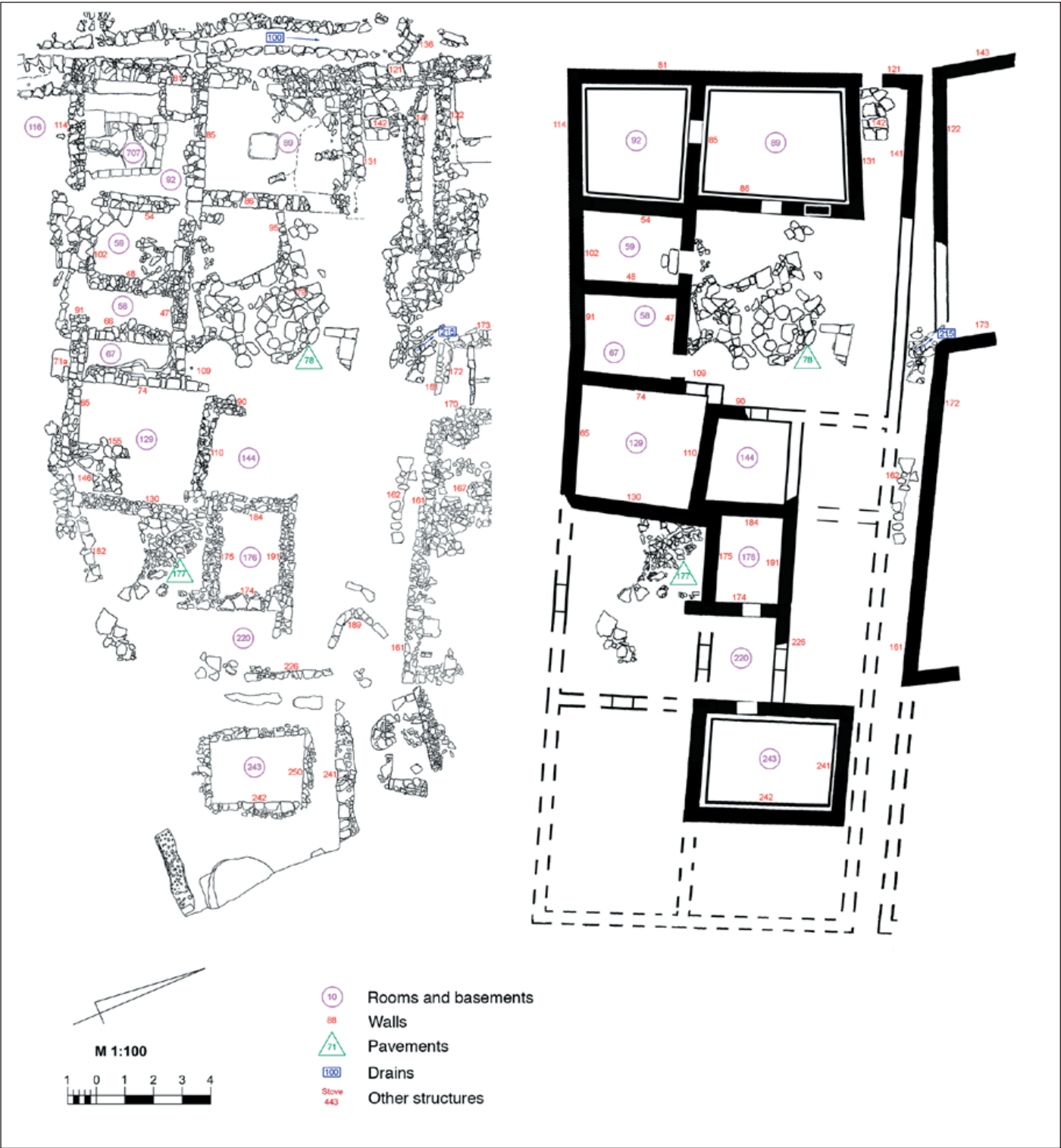



1 • House II-3, staircase from the Western Longitudinal Street. To the right the external walls of the adjacent Houses II-1 and II-3. View from the east.



2 • House II-3. To the left the remains of the pavement of the courtyard, in the middle Basement 89. View from the northeast.

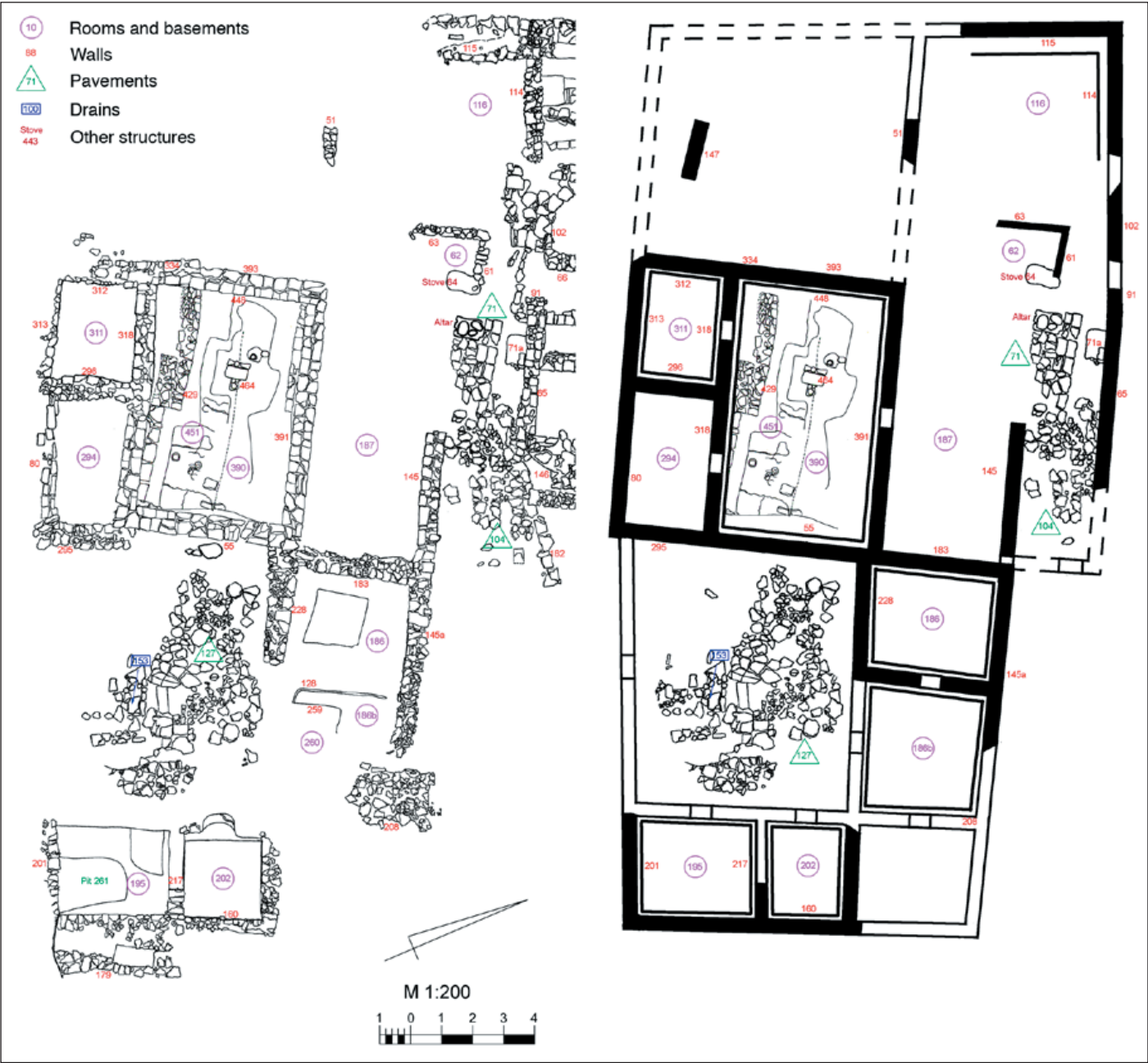

1-2 • Houses II-5 and II-6. Plan and reconstruction.



1 • House II-5, altar and platform. View from the east.



2 • House II-5, altar with pebbles and a vessel. View from the north.



1 • House II-5, Basement 390 during excavation. In the upper left corner Basement 311. View from the northeast.



2 • House II-5, Basement 390, southern Wall 318.



3 • House II-6, Basements 202 and 195, eastern walls. View from the west.

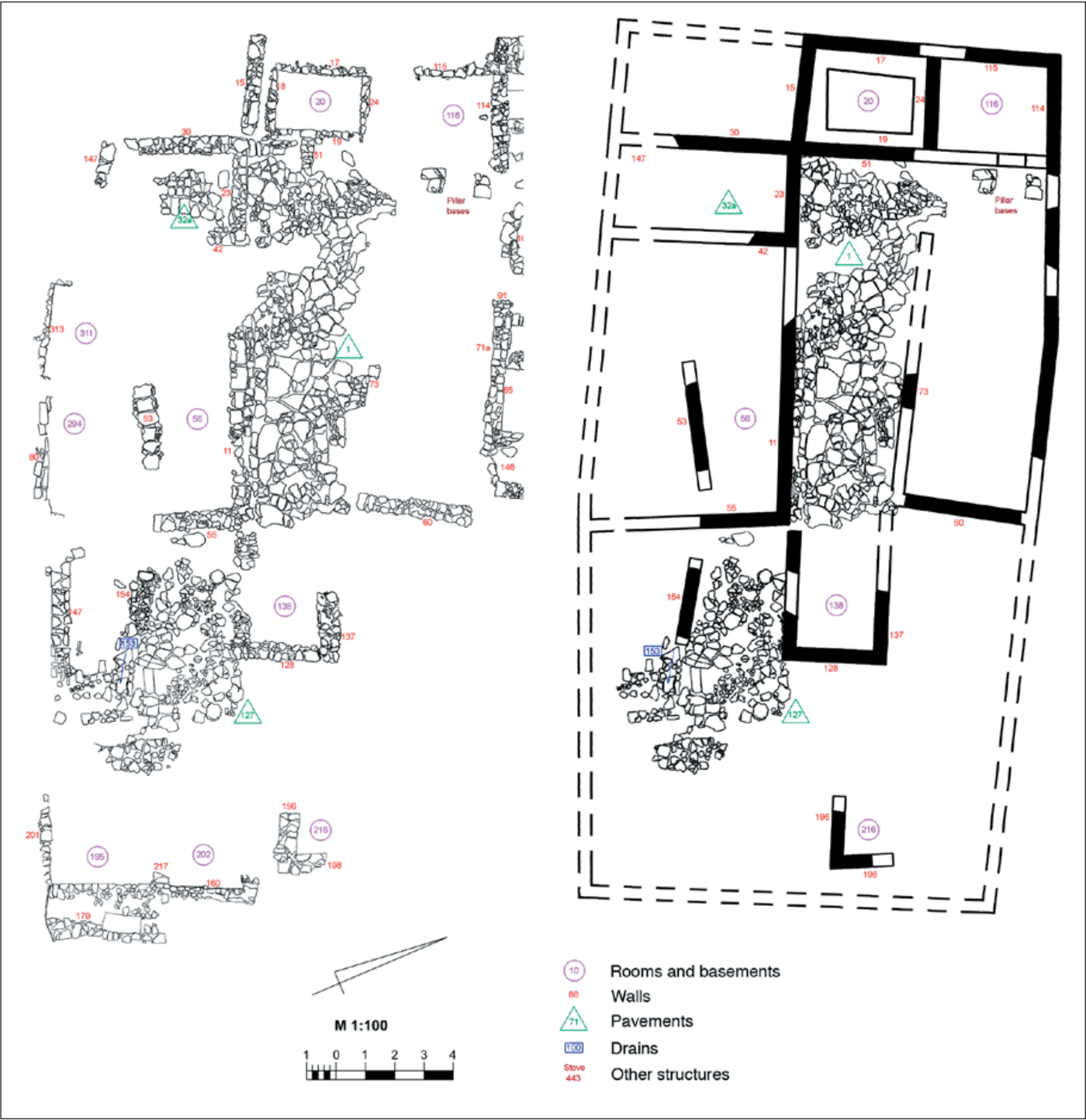

1-2 • House II-7. Plan and reconstruction.



1 • House II-7, pavement in courtyard. View from the east.



2 • House II-7, pavement in courtyard. In the foreground Basement 20. View from the west.



1 • House II-7, bases of pilasters. View from the south.

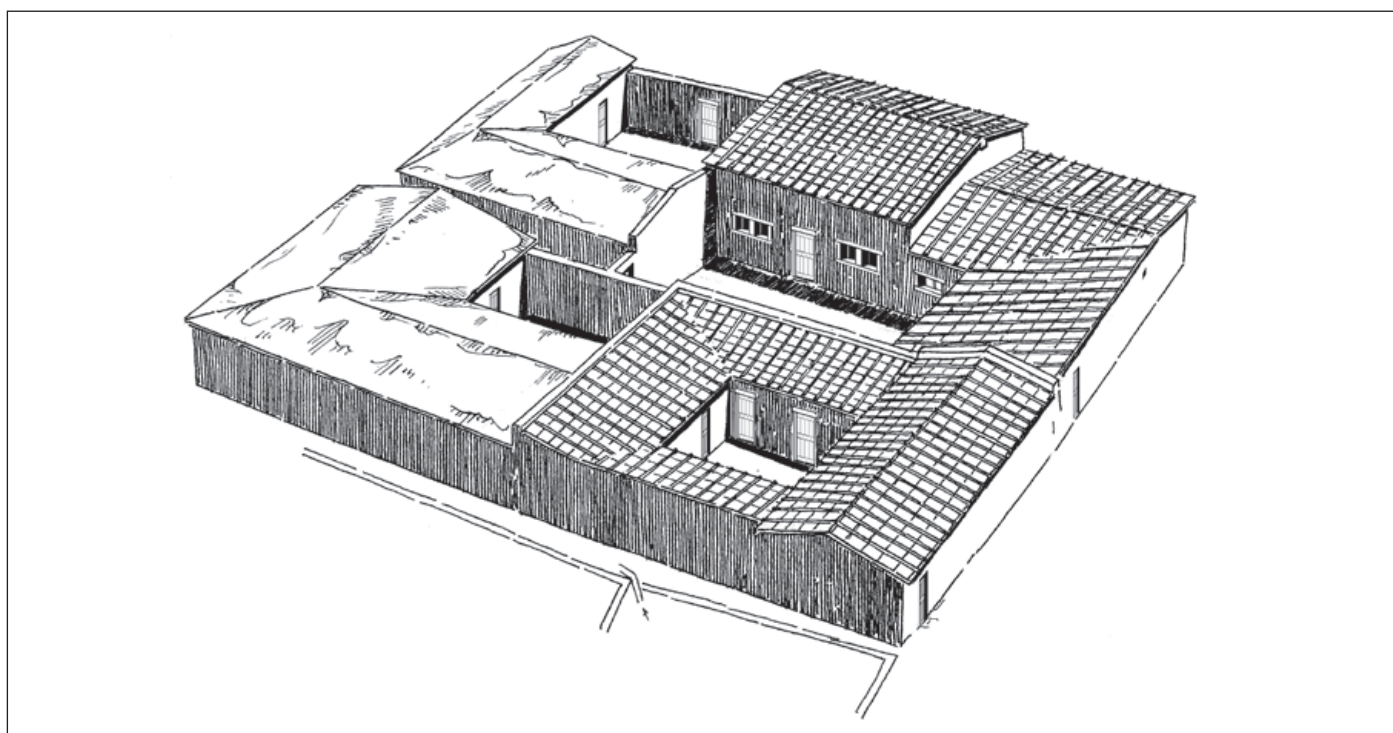

2 • General view of the Northern Houseblock from northwest. Reconstruction.



The Western and Central Houseblocks. Plan.





1 • House III-1, internal basement wall. View from the west.



2 • House III-2. View from the southeast.



3 • House III-2. View from the southwest.



1 • House III-2 after restoration. In the foreground the remains of House III-1. View from the northwest.



2 • House III-2, staircase leading from the Western Longitudinal Street to Room 255. View from the west.



1 • House III-3, pavement in courtyard and Room 278 located to the north of the courtyard. View from the southwest.



2 • House III-3, Room 278. In the southern wall of the room are the remains of a doorway. View from the northwest.



1 • House III-3, Basement 368 under Room 278, southern wall.



2 • House III-3, andron. View from the southeast.



1 • House III-3, andron. View from the northwest.

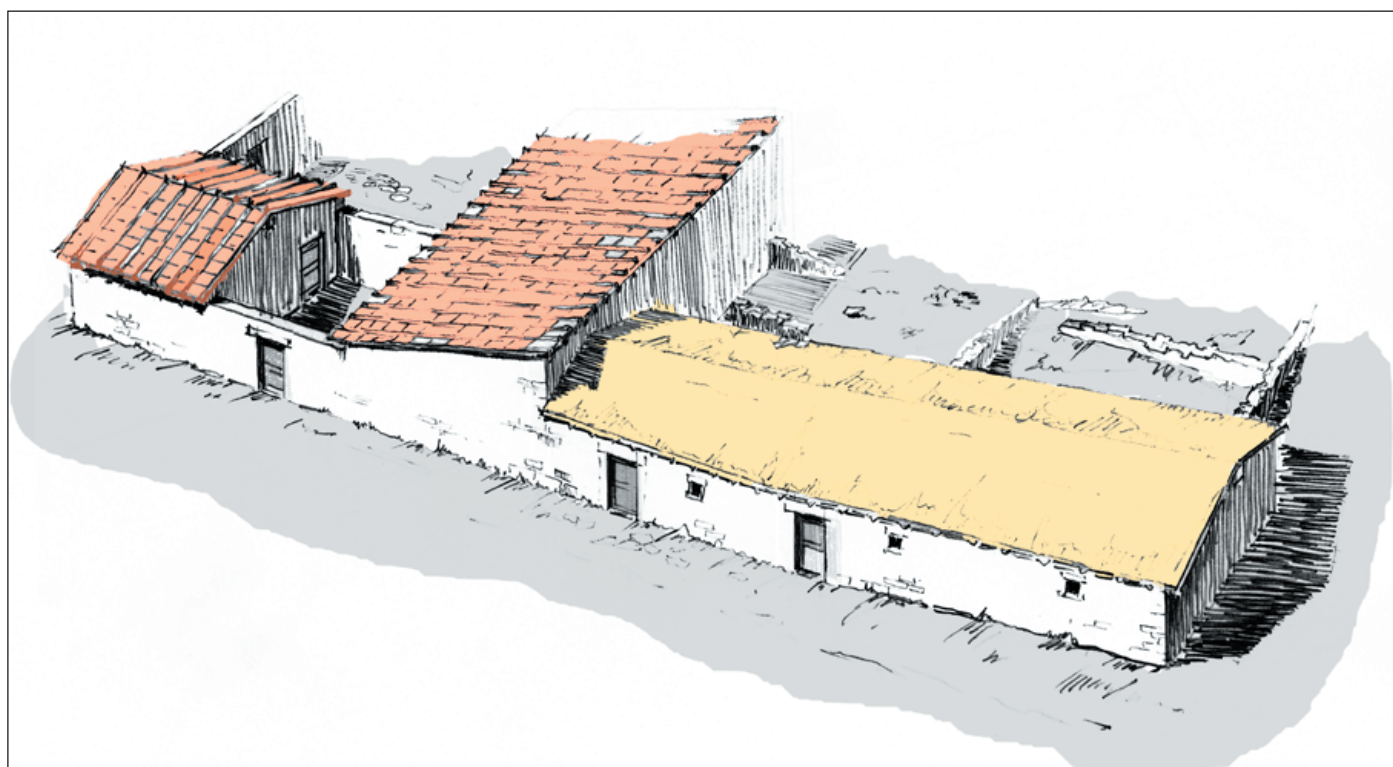

2 • General view of the Western Houseblock from northeast. Reconstruction.



1 • View from the south over the northern half of the Central Houseblock. To the left, House IV-1, Basements 253 and 257 and the *prothyron*; to the right, House IV-2 and Basements 287 and 280.



2 • Houses IV-1 and IV-2. View from the west.



1 • House IV-1, Basement 253. View from the east.



2 • House IV-1, Basement 253. View from the southeast.



1 • House IV-1, Basement 253. View from the north.



2 • House IV-1, Basement 253. Lower part of pithos of secondary use.



3 • House IV-1, Basement 253. Amphoras.



1 • House IV-2, Basement 280. View from the east.

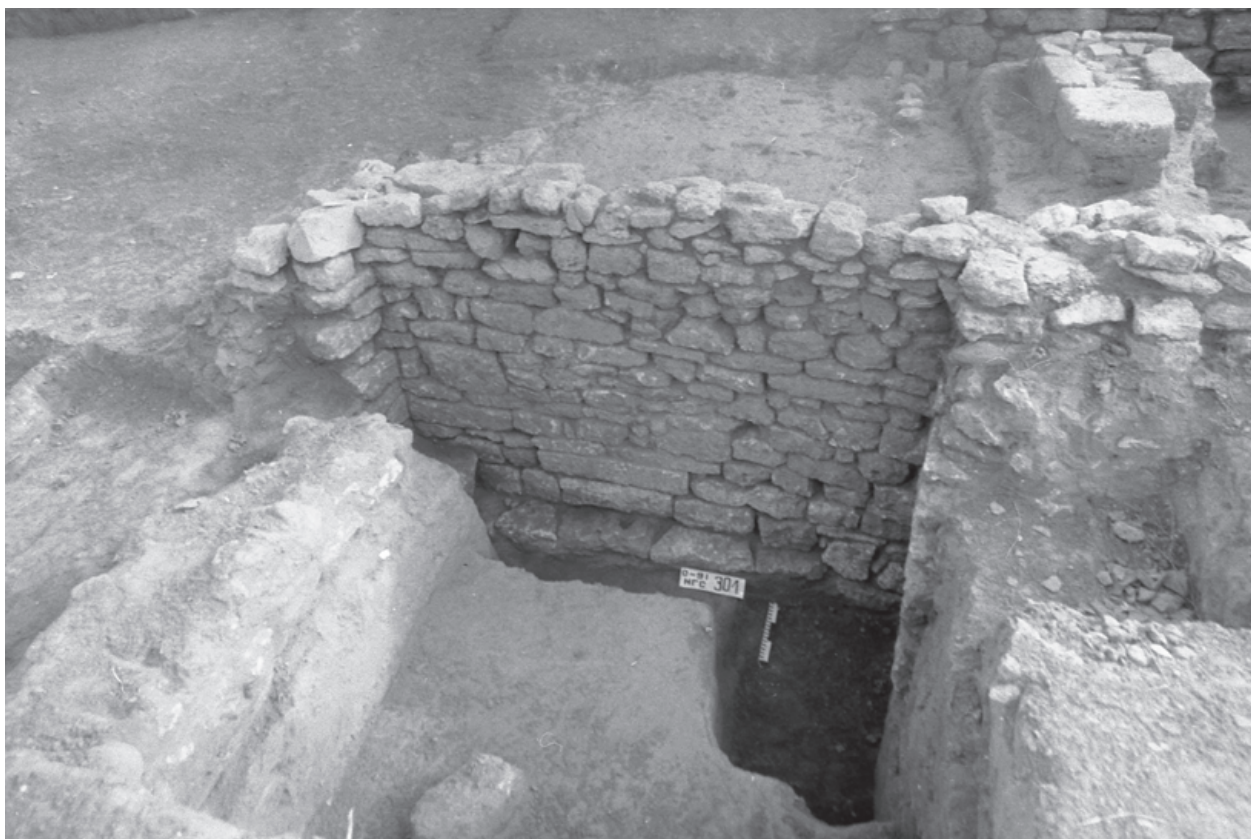

2 • House IV-2, Basement 301, southern wall. View from the north.



1 • House IV-2, Basement 302,
western wall.



2 • House IV-2, Basement 302,
northern wall.



1 • House IV-2, Room 302 with altar. View from the southeast.



2 • House IV-2, altar in Room 302.



1 • House IV-3, Basement 343. View from the south.



2 • House IV-4, Basement 353. In the distance, a staircase leading from the courtyard to the basement. View from the north.



1 • House IV-4, Basement 353, east wall with doorway leading to Basement 351.



2 • House IV-4, Basement 351. View from the east.



1 • House IV-4, Basement 351 and the remains of an earlier basement opened under Floor 392. View from the south.

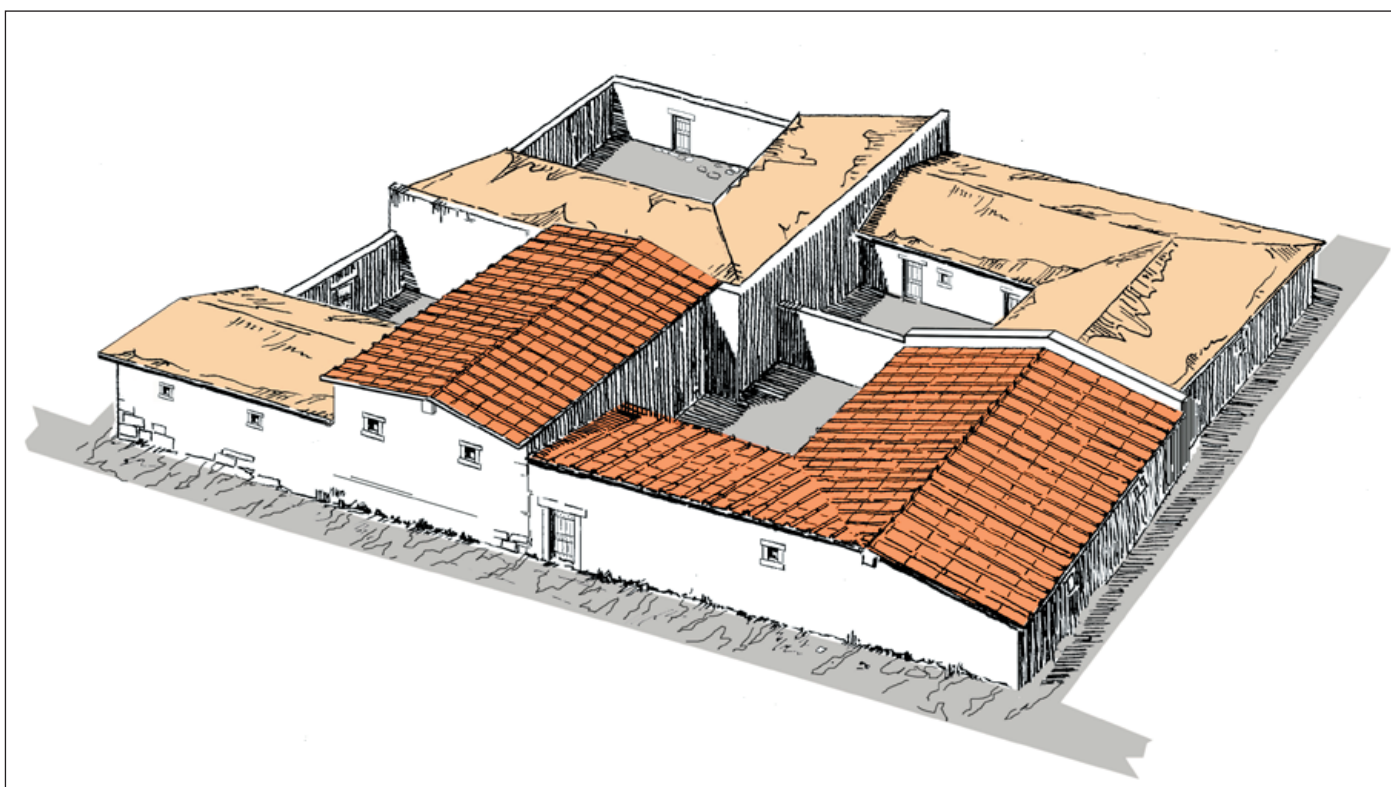

2 • General view of the Central Houseblock from northeast. Reconstruction.



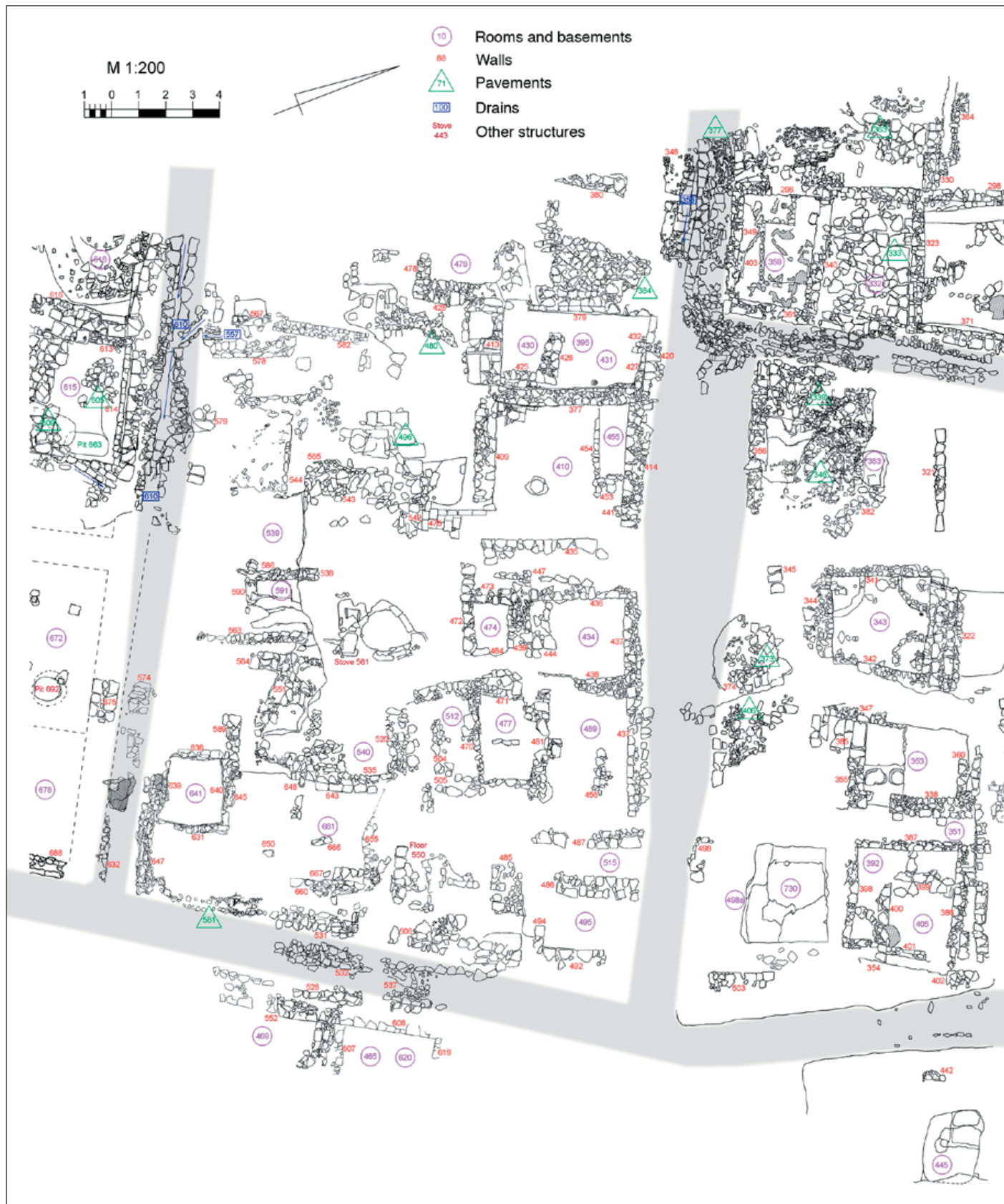

Southern Houseblock. Plan.

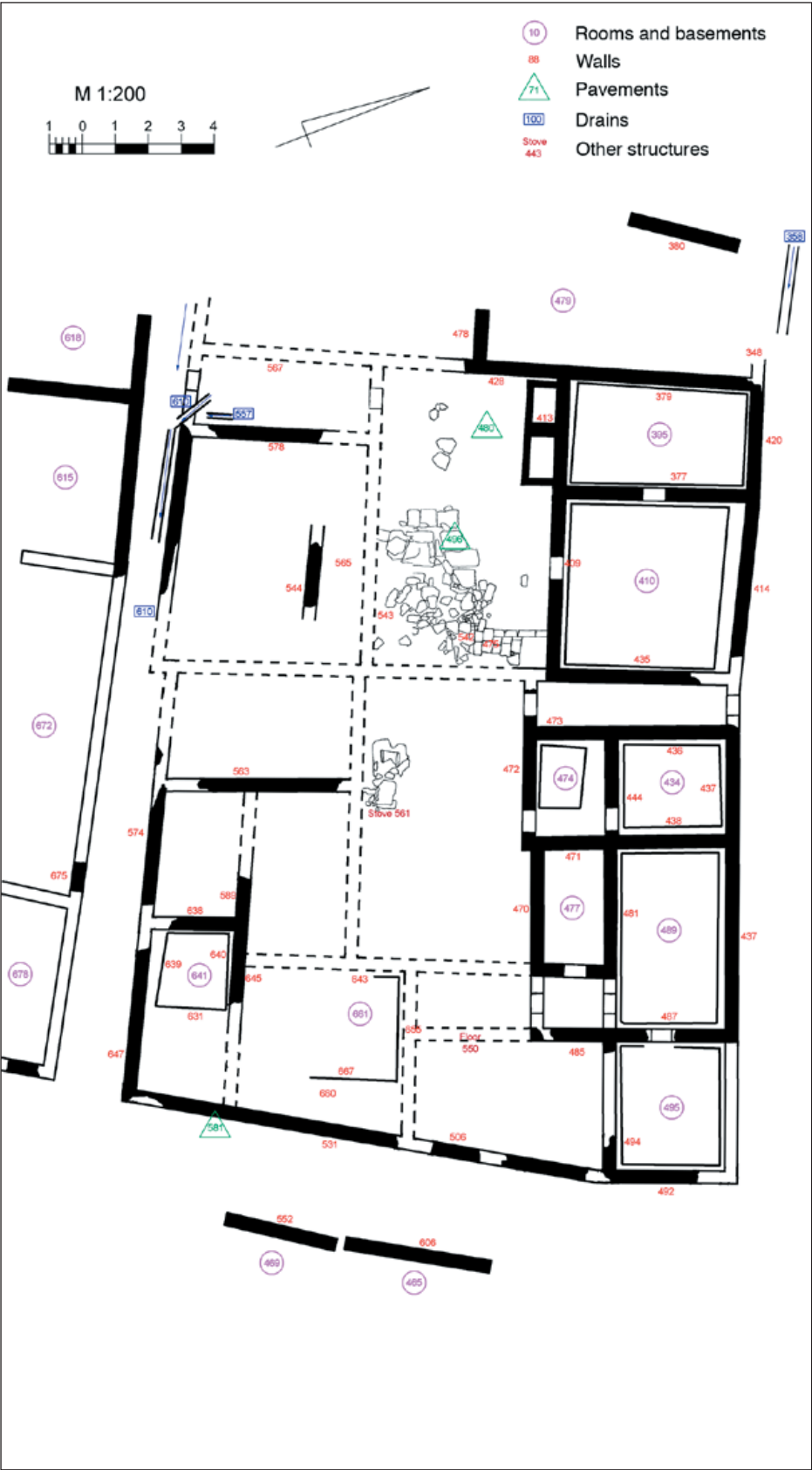

Houses of the Southern Houseblock. Reconstruction.



1 • House VI-2, Basements 395 and 410. In the foreground to the right, the remains of the pavement of courtyard. View from the south.



2 • House VI-2, Basements 395 and 410 after restoration. View from the north.



1 • House VI-2, southern wall of Basement 410.



2 • House VI-2, western wall of Basement 410.



1 • House VI-2, staircase in Basement 410. View from northeast.



2 • House VI-2, Basement 395. View from the West.



1 • House VI-2, Basement 395. View from the north.



2 • House VI-2, Basement 395. Window aperture. View from the east.



1 • House VI-3, walls of Basements 495, 489, and 434. View from the northeast.



2 • House VI-3, Basement 434. View from the south.



1 • House VI-3, western wall of Basement 434.



2 • House VI-3, southern wall of Basement 489. View from the north.



1 • House VI-3, Basement 489.



2 • House VI-3, Stove 561. View from the southwest.

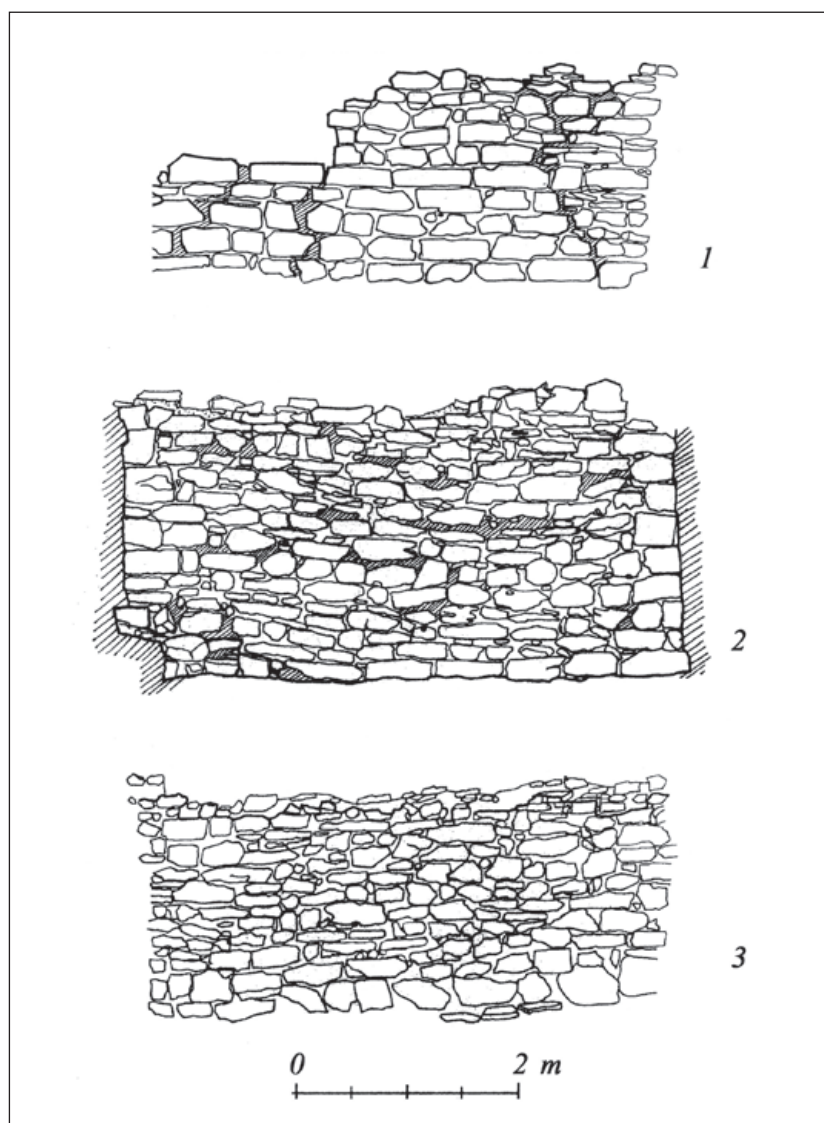

1 • Masonry techniques. 1: single-row wall of polygonal plates and blocks (Wall 320); 2: single-row, irregular (Wall 377); 3: irregular (Wall 370).

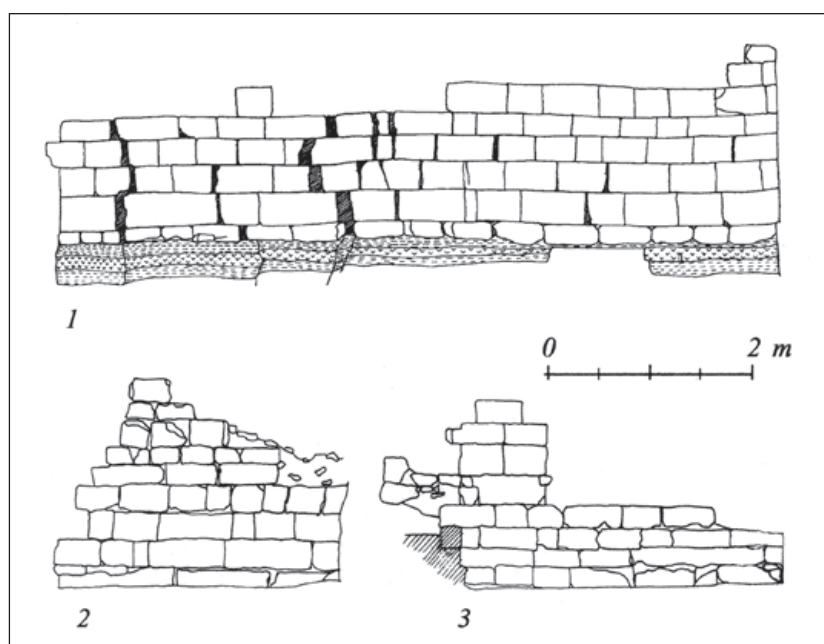

2 • Single-row of orthogonal plates and blocks. 1: Wall 318; 2: Wall 71; 3: Wall 72.



1 • Houses with Γ-shaped arrangement of rooms. Sector NGS, Central Houseblock: 1: House IV-4; 2: House IV-2; 3: House IV-3; 5: House IV-1. Sector NGS, Northwestern Houseblock: 8: House I-1. Sector NGS, Northern Houseblock: 4: House II-4; 6: House II-6. Sector I: 7: House I-2.

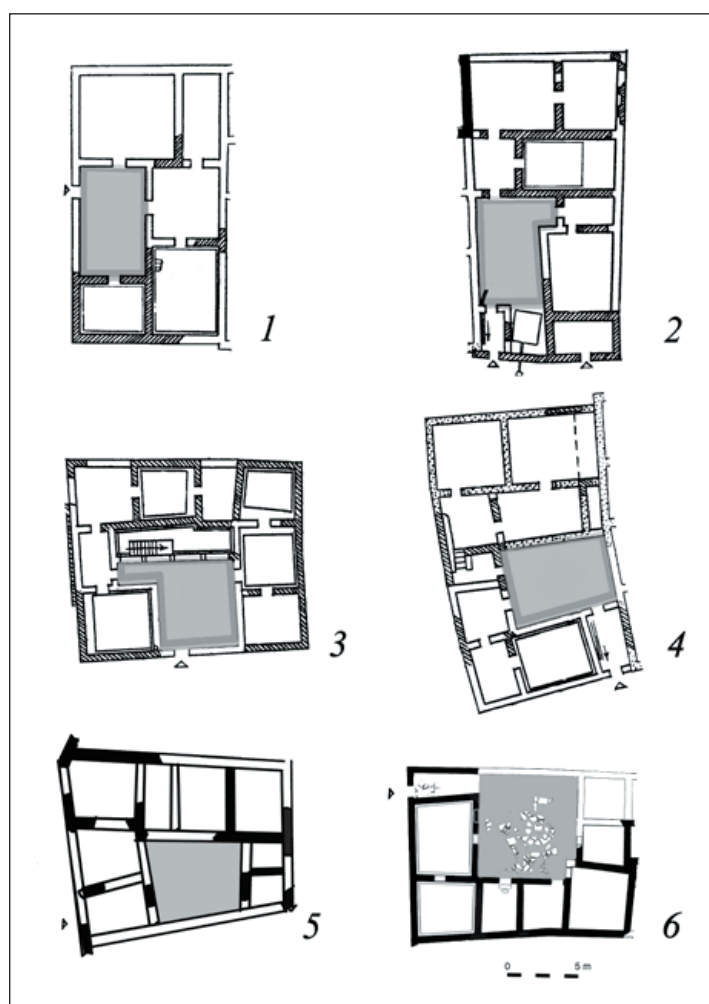

2 • Houses with Π-shaped arrangement of rooms: 1: House A-4; 2: House A-3; 3: House E-1; 4: House E-2; 5: House E-6; 6: Sector NGS, House II-3.



Houses of Sector NGS. Reconstruction of lay-out.

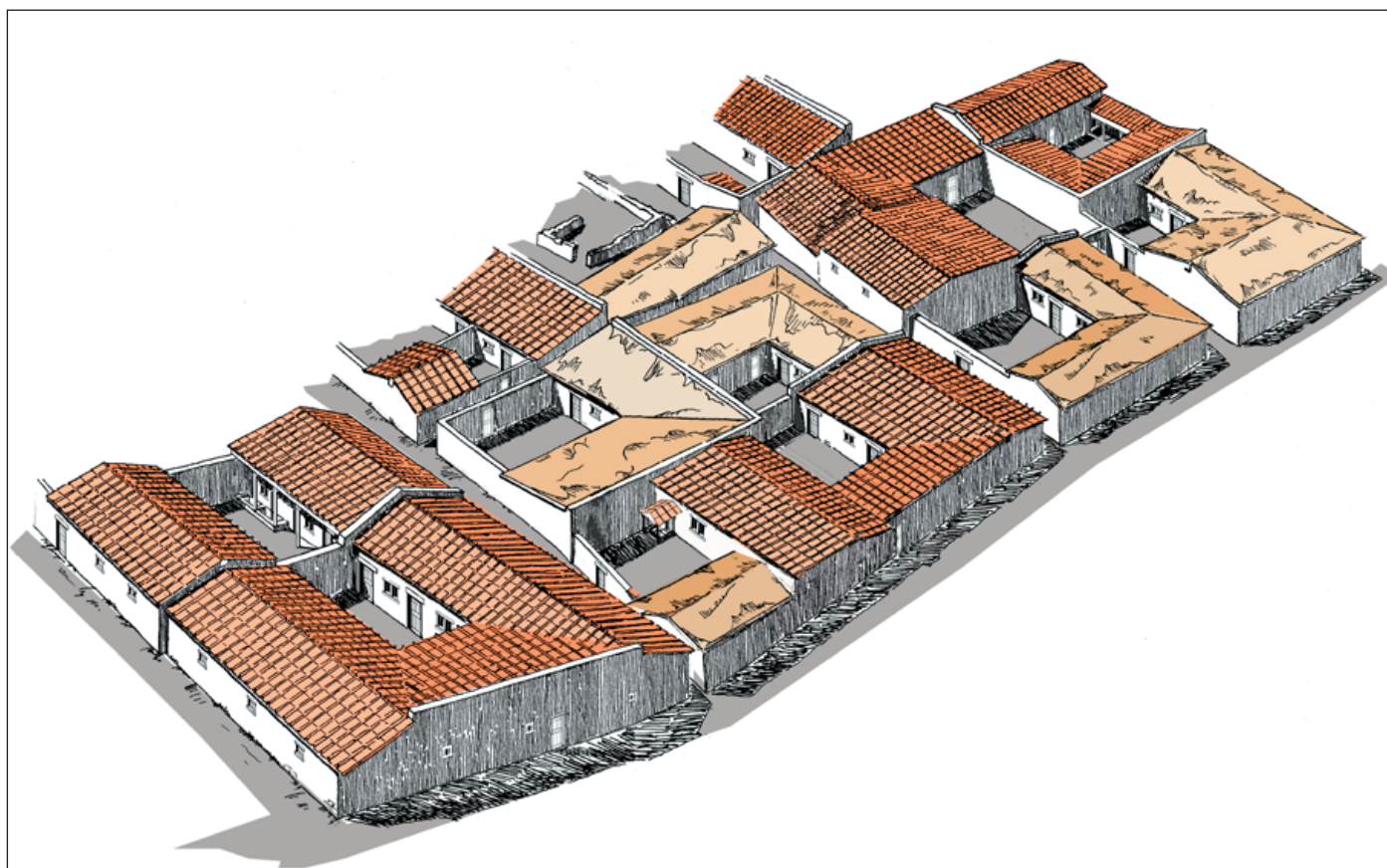

General view of the houseblocks in Sector NGS. Reconstruction. View from southeast.